

## Inline Ejectors SLP

Suction rate from 8 l/min to 16 l/min

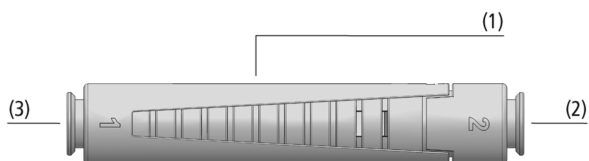

Inline Ejectors SLP



System design Inline Ejectors SLP

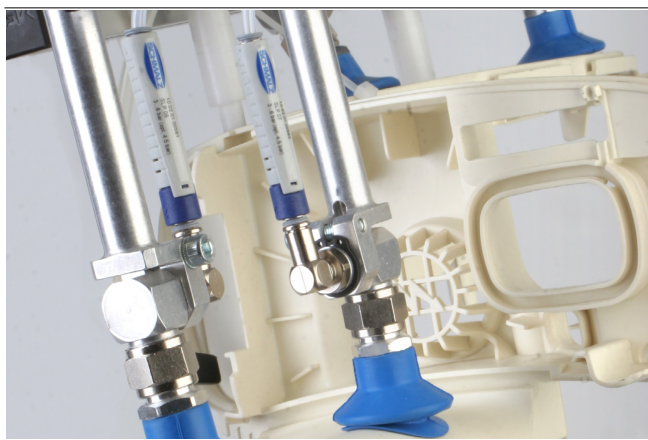

Decentral vacuum generation by inline ejectors SLP when handling plastic injection molded parts

### Suitability for industry specific applications

#### Application

- Inline ejector for mounting directly in the hose line
- Handling of electronic components
- Vacuum generation in handling systems with restricted space
- Use in separation systems for plastic and sheet-metal machining

#### Design

- Two piece housing made of light, impact resistant plastic (1)
- Axial connection of compressed air (3) and vacuum (2) with quick action push-in couplings for hose diameter 4 mm
- Vacuum generator with single-stage nozzle with 0.5 and 0.7 mm diameter
- Air outlet with good flow characteristics
- Attractive industrial design in a slim "10 mm" construction

#### Product highlights

- Inline ejector with axial connections for installation directly into the hose line
- Ideal for highly dynamic processes due to its low weight (5 g)
- Optimized air consumption with high suction rate and vacuum value
- Slim plastic housing allows installation even in the smallest of spaces
- Push-in connection saves additional connection elements

# Inline Ejectors SLP

Suction rate from 8 l/min to 16 l/min

## Designation code Inline Ejectors SLP

<b>SLP</b>	-	<b>05</b>	-	<b>S01</b>
1		2		3

### 1 – Abbreviated designation

Code	Version
SLP	SLP

### 2 – Nozzle size

Code	Diameter in mm
05...07	ø 0.5 and 0.7

### 3 – Connection

Code	Connection
S01	Quick connect push-in coupling 1

Inline ejector SLP is delivered as a ready-to-connect product.

## Ordering data Inline Ejectors SLP

Type	Part no.
SLP 05 S01	10.02.01.00561
SLP 07 S01	10.02.01.00562

## Technical data Inline Ejectors SLP

Type	Nozzle diameter [mm]	Degree of evacuation [%]	Suction rate (max.) [l/min]	Suction rate (max.) [m³/h]	Air consumption suction [l/min]*	Air consumption suction [m³/h]**
SLP 05 S01	0.5	85	8	0.5	13	0.8
SLP 07 S01	0.7	85	16	1.0	25	1.5

\* At optimal operating pressure

\*\* At optimal operating pressure

Type	Sound pressure level suction [dB(A)]	Sound pressure level free [dB(A)]	Optimal operating pressure [bar]	Recommended hose internal diameter compressed air [mm]*	Weight [g]	Operating temperature [°C]
SLP 05 S01	52	60	4.5	2	5	0 ... 60 °C
SLP 07 S01	63	63	4.5	2	5	0 ... 60 °C

\* For max. length 2 m

# Inline Ejectors SLP

Suction rate from 8 l/min to 16 l/min

## Performance data Inline Ejectors SLP

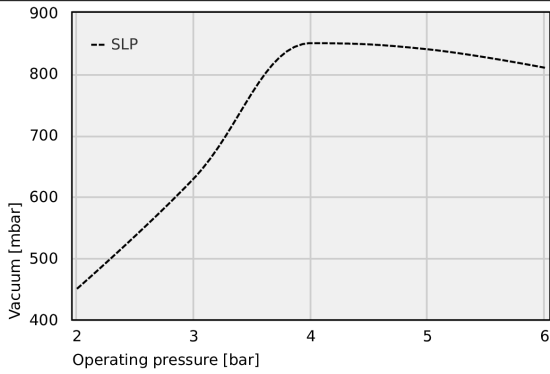

Achievable vacuum at various operating pressures

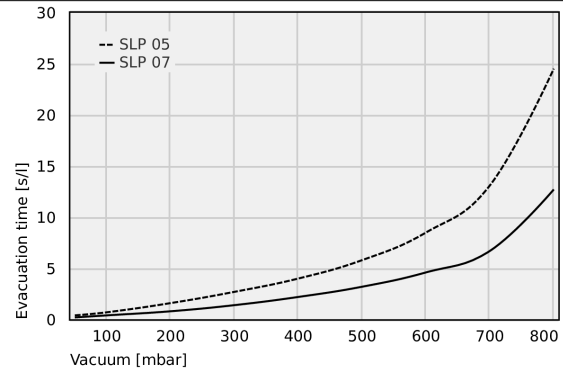

Evacuation time for various vacuum ranges [s/l]

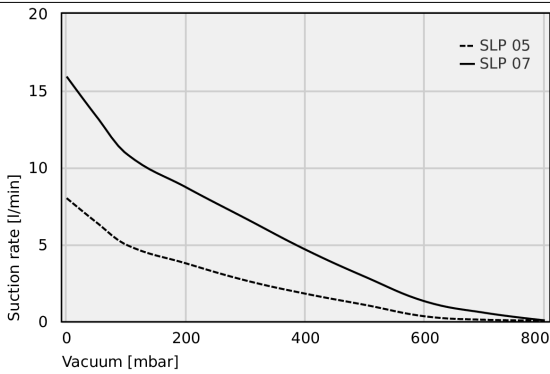

Suction rate at various degrees of evacuation [l/min]

## Achievable vacuum at various operating pressures

	2	3	4	5	6
SLP	450.00	630.00	850.00	840.00	810.00

## Inline Ejectors SLP

Suction rate from 8 l/min to 16 l/min

### 📄 Evacuation time for various vacuum ranges [s/l]

	50	100	200	300	400	500	600	700	800
SLP 05	0.40	0.70	1.60	2.70	4.00	5.80	8.50	13.10	24.50
SLP 07	0.20	0.40	0.80	1.40	2.20	3.20	4.60	6.70	12.70

### 📄 Suction rate at various degrees of evacuation [l/min]

	0	50	100	200	300	400	500	600	700	800
SLP 05	8.00	6.42	4.97	3.76	2.65	1.79	1.06	0.32	0.10	0.05
SLP 07	15.90	13.30	10.89	8.70	6.67	4.65	2.88	1.29	0.55	0.06

## Inline Ejectors SLP

Suction rate from 8 l/min to 16 l/min

### Design data Inline Ejectors SLP

---

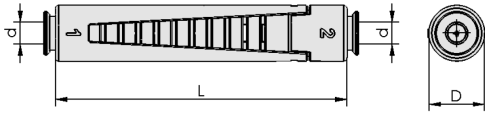

---

SLP

## Inline Ejectors SLP

Suction rate from 8 l/min to 16 l/min

### Design data Inline Ejectors SLP

Type	d [mm]	D [mm]	L [mm]
SLP 05 S01	4	10	57
SLP 07 S01	4	10	57